

**Disclosure Plan**  
**Proposed Lot 1 on SP347417**

Current RP Description: Lot 1 on RP142419

Level Datum: AHD vide PSM70607

Project Meridian: MGA zone 56

**Legend: Design**

- Stormwater Line
- Stormwater Tank
- Sewer Line
- Water Line
- Earthworks Pad
- Design Contours

**Cut / Fill**

- |              |               |
|--------------|---------------|
| 3.0-2.5m Cut | 0.0-0.5m Fill |
| 2.5-2.0m Cut | 0.5-1.0m Fill |
| 2.0-1.5m Cut | 1.0-1.5m Fill |
| 1.5-1.0m Cut | 1.5-2.0m Fill |
| 1.0-0.5m Cut | 2.0-2.5m Fill |
| 0.5-0.0m Cut | 2.5-3.0m Fill |

Compaction of all fill placed as part of the civil works program is to be inspected and tested to Level 1 Inspection and Testing Standards in accordance with the Australian Standard AS 3798 - 2007, "Guidelines on Earthworks for Commercial and Residential Developments".

Any licence to use, reference or reproduce this document for any purpose whatsoever is restricted to the terms of the agreement between Trilogy Survey Solutions and the instructing party.

The property boundaries shown on this plan have been compiled from draft survey plan SP347417 DRAFT and are subject to final survey and local authority approvals.

Ancillary information (areas of fill, services, streetscaping, etc) is compiled from engineering design provided by ADG drawing numbers 27303\_C01-C43 Rev A. This information is indicative only and is subject to the approval of relevant authorities and civil construction.

Relevant development approvals relating to this project are RAL 23/0103 and OPW 24/0054.

This plan should be read with reference to the proposed draft survey plan SP347417 DRAFT and the approved engineering design plans.

AMENDMENTS	DATE
A	
B	

TRILOGY SURVEY SOLUTIONS PTY LTD  
 (ACN 659 242 538) certify that the details  
 shown on this sketch plan are correct

30/8/2024  
 Date

Scale:   
 1:250 (Before Reduction)

Drawing Number: TSS-231049-001-A Sheet 1 of 16

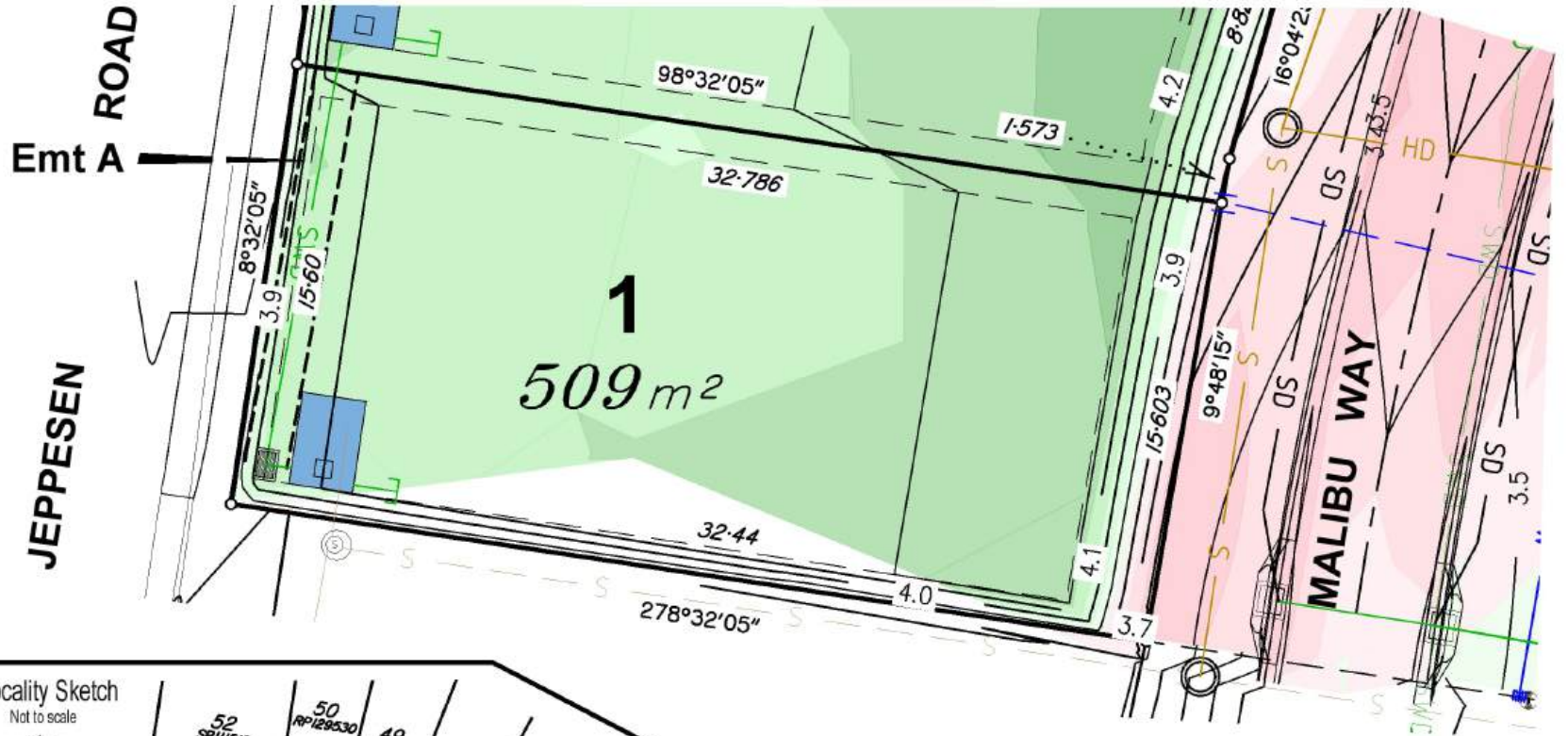

**Locality Sketch**

Not to scale



**Notes**  
 No part of this plan may be copied unless this note is included.  
 This plan has been prepared for Mywash Pty Ltd for the purpose of disclosure under the Land Sales Act. It is not to be used by any other person's or corporation's or for any other purpose.



CONSULTING SURVEYORS  
 MERMAID WATERS | GOLD COAST

0431 400 670  
 wayneg@trilogys.com.au

# Disclosure Plan Proposed Lot 2 on SP347417

Current RP Description: Lot 1 on RP142419

Level Datum: AHD vide PSM70607

Project Meridian: MGA zone 56

### Legend: Design

- Stormwater Line
- Stormwater Tank
- Sewer Line
- Water Line
- Earthworks Pad
- 3.9 Design Contours

### Cut / Fill

- |              |               |
|--------------|---------------|
| 3.0-2.5m Cut | 0.0-0.5m Fill |
| 2.5-2.0m Cut | 0.5-1.0m Fill |
| 2.0-1.5m Cut | 1.0-1.5m Fill |
| 1.5-1.0m Cut | 1.5-2.0m Fill |
| 1.0-0.5m Cut | 2.0-2.5m Fill |
| 0.5-0.0m Cut | 2.5-3.0m Fill |

Compaction of all fill placed as part of the civil works program is to be inspected and tested to Level 1 Inspection and Testing Standards in accordance with the Australian Standard AS 3798 - 2007, "Guidelines on Earthworks for Commercial and Residential Developments".

Any licence to use, reference or reproduce this document for any purpose whatsoever is restricted to the terms of the agreement between Trilogy Survey Solutions and the instructing party.

The property boundaries shown on this plan have been compiled from draft survey plan SP347417 DRAFT and are subject to final survey and local authority approvals.

Ancillary information (areas of fill, services, streetscaping, etc) is compiled from engineering design provided by ADG drawing numbers 27303\_C01-C43 Rev A. This information is indicative only and is subject to the approval of relevant authorities and civil construction.

Relevant development approvals relating to this project are RAL 23/0103 and OPW 24/0054.

This plan should be read with reference to the proposed draft survey plan SP347417 DRAFT and the approved engineering design plans.

AMENDMENTS	DATE
A	
B	

TRILOGY SURVEY SOLUTIONS PTY LTD  
(ACN 659 242 538) certify that the details  
shown on this sketch plan are correct

30/8/2024  
Date

Scale: 0 2.5 5 7.5  
1:250 (Before Reduction)

@A4  
Drawing Number: TSS-231049-001-A Sheet 2 of 16



### Locality Sketch

Not to scale



### Notes

No part of this plan may be copied unless this note is included.

This plan has been prepared for Mywash Pty Ltd for the purpose of disclosure under the Land Sales Act. It is not to be used by any other person's or corporation's or for any other purpose.



NORTH  
(Meridian MGA zone 56)



**Trilogy**  
Survey Solutions

CONSULTING SURVEYORS  
MERMAID WATERS | GOLD COAST

0431 400 670  
wayneg@trilogys.com.au

**Disclosure Plan**  
**Proposed Lot 3 on SP347417**

Current RP Description: Lot 1 on RP142419

Level Datum: AHD vide PSM70607

Project Meridian: MGA zone 56

**Legend: Design**

- Stormwater Line
- Stormwater Tank
- Sewer Line
- Water Line
- Earthworks Pad
- 3.9 Design Contours

**Cut / Fill**

- |              |               |
|--------------|---------------|
| 3.0-2.5m Cut | 0.0-0.5m Fill |
| 2.5-2.0m Cut | 0.5-1.0m Fill |
| 2.0-1.5m Cut | 1.0-1.5m Fill |
| 1.5-1.0m Cut | 1.5-2.0m Fill |
| 1.0-0.5m Cut | 2.0-2.5m Fill |
| 0.5-0.0m Cut | 2.5-3.0m Fill |

Compaction of all fill placed as part of the civil works program is to be inspected and tested to Level 1 Inspection and Testing Standards in accordance with the Australian Standard AS 3798 - 2007, "Guidelines on Earthworks for Commercial and Residential Developments".

Any licence to use, reference or reproduce this document for any purpose whatsoever is restricted to the terms of the agreement between Trilogy Survey Solutions and the instructing party.

The property boundaries shown on this plan have been compiled from draft survey plan SP347417 DRAFT and are subject to final survey and local authority approvals.

Ancillary information (areas of fill, services, streetscaping, etc) is compiled from engineering design provided by ADG drawing numbers 27303\_C01-C43 Rev A. This information is indicative only and is subject to the approval of relevant authorities and civil construction.

Relevant development approvals relating to this project are RAL 23/0103 and OPW 24/0054.

This plan should be read with reference to the proposed draft survey plan SP347417 DRAFT and the approved engineering design plans.

AMENDMENTS	DATE
A	
B	

TRILOGY SURVEY SOLUTIONS PTY LTD  
(ACN 659 242 538) certify that the details  
shown on this sketch plan are correct

30/8/2024  
Date

Scale: 1:250 (Before Reduction)

@A4  
Drawing Number: TSS-231049-001-A Sheet 3 of 16

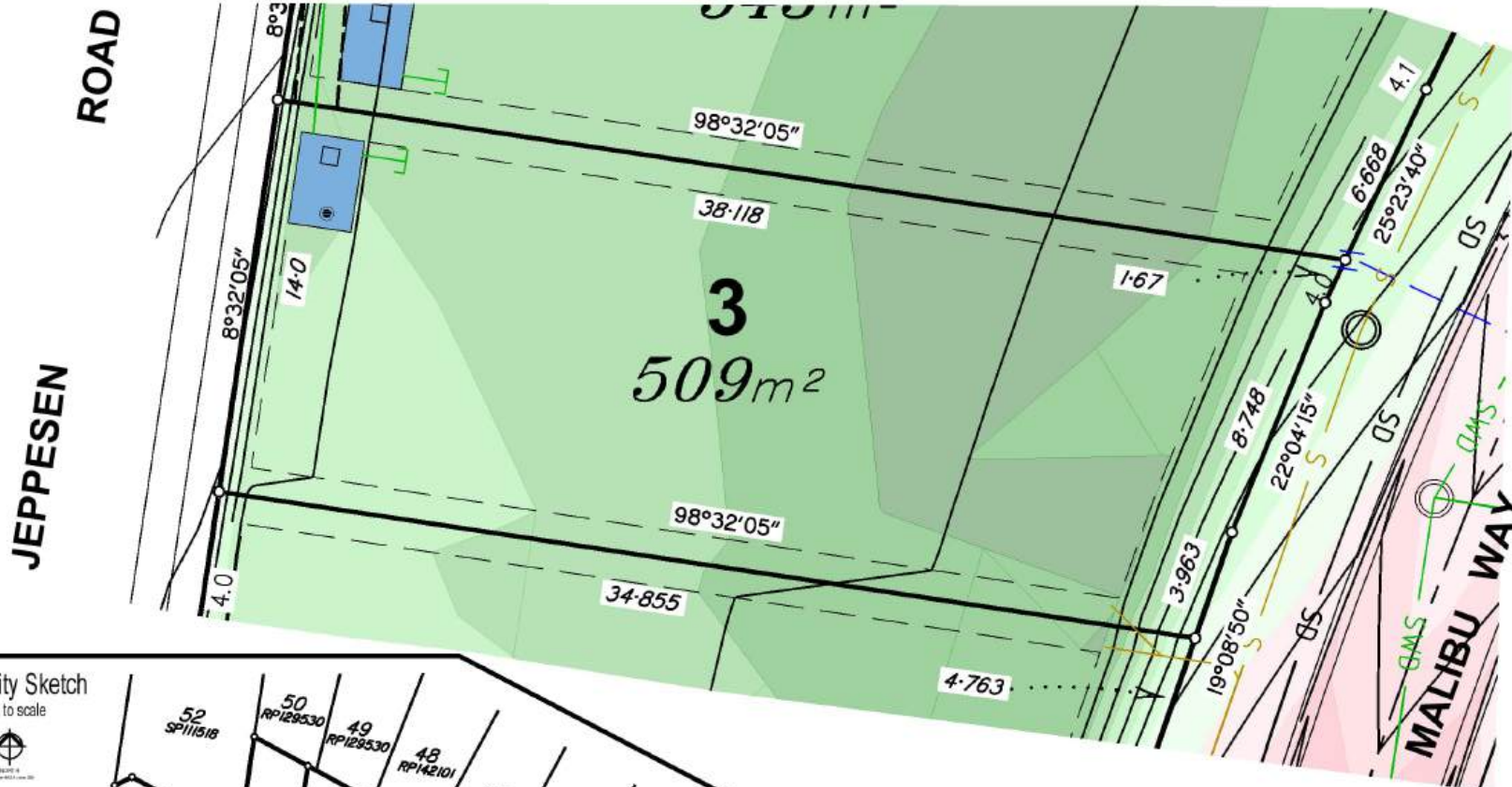

**Locality Sketch**

Not to scale



**Notes**

No part of this plan may be copied unless this note is included.

This plan has been prepared for Mywash Pty Ltd for the purpose of disclosure under the Land Sales Act. It is not to be used by any other person's or corporation's or for any other purpose.



NORTH  
(Meridian MGA zone 56)



**Trilogy**  
Survey Solutions

CONSULTING SURVEYORS  
MERMAID WATERS | GOLD COAST

☎ 0431 400 670

✉ wayneg@trilogys.com.au

**Disclosure Plan**  
**Proposed Lot 4 on SP347417**

Current RP Description: Lot 1 on RP142419

Level Datum: AHD vide PSM70607

Project Meridian: MGA zone 56

**Legend: Design**

- Stormwater Line
- Stormwater Tank
- Sewer Line
- Water Line
- Earthworks Pad
- Design Contours

**Cut / Fill**

- |  |              |  |               |
|--|--------------|--|---------------|
|  | 3.0-2.5m Cut |  | 0.0-0.5m Fill |
|  | 2.5-2.0m Cut |  | 0.5-1.0m Fill |
|  | 2.0-1.5m Cut |  | 1.0-1.5m Fill |
|  | 1.5-1.0m Cut |  | 1.5-2.0m Fill |
|  | 1.0-0.5m Cut |  | 2.0-2.5m Fill |
|  | 0.5-0.0m Cut |  | 2.5-3.0m Fill |

Compaction of all fill placed as part of the civil works program is to be inspected and tested to Level 1 Inspection and Testing Standards in accordance with the Australian Standard AS 3798 - 2007, "Guidelines on Earthworks for Commercial and Residential Developments".

Any licence to use, reference or reproduce this document for any purpose whatsoever is restricted to the terms of the agreement between Trilogy Survey Solutions and the instructing party.

The property boundaries shown on this plan have been compiled from draft survey plan SP347417 DRAFT and are subject to final survey and local authority approvals.

Ancillary information (areas of fill, services, streetscaping, etc) is compiled from engineering design provided by ADG drawing numbers 27303\_C01-C43 Rev A. This information is indicative only and is subject to the approval of relevant authorities and civil construction.

Relevant development approvals relating to this project are RAL 23/0103 and OPW 24/0054.

This plan should be read with reference to the proposed draft survey plan SP347417 DRAFT and the approved engineering design plans.

AMENDMENTS		DATE
A	DESCRIPTION	
B		

TRILOGY SURVEY SOLUTIONS PTY LTD  
 (ACN 659 242 538) certify that the details  
 shown on this sketch plan are correct

30/8/2024  
 Date

Scale:   
 1:250 (Before Reduction)

Drawing Number: TSS-231049-001-A Sheet 4 of 16

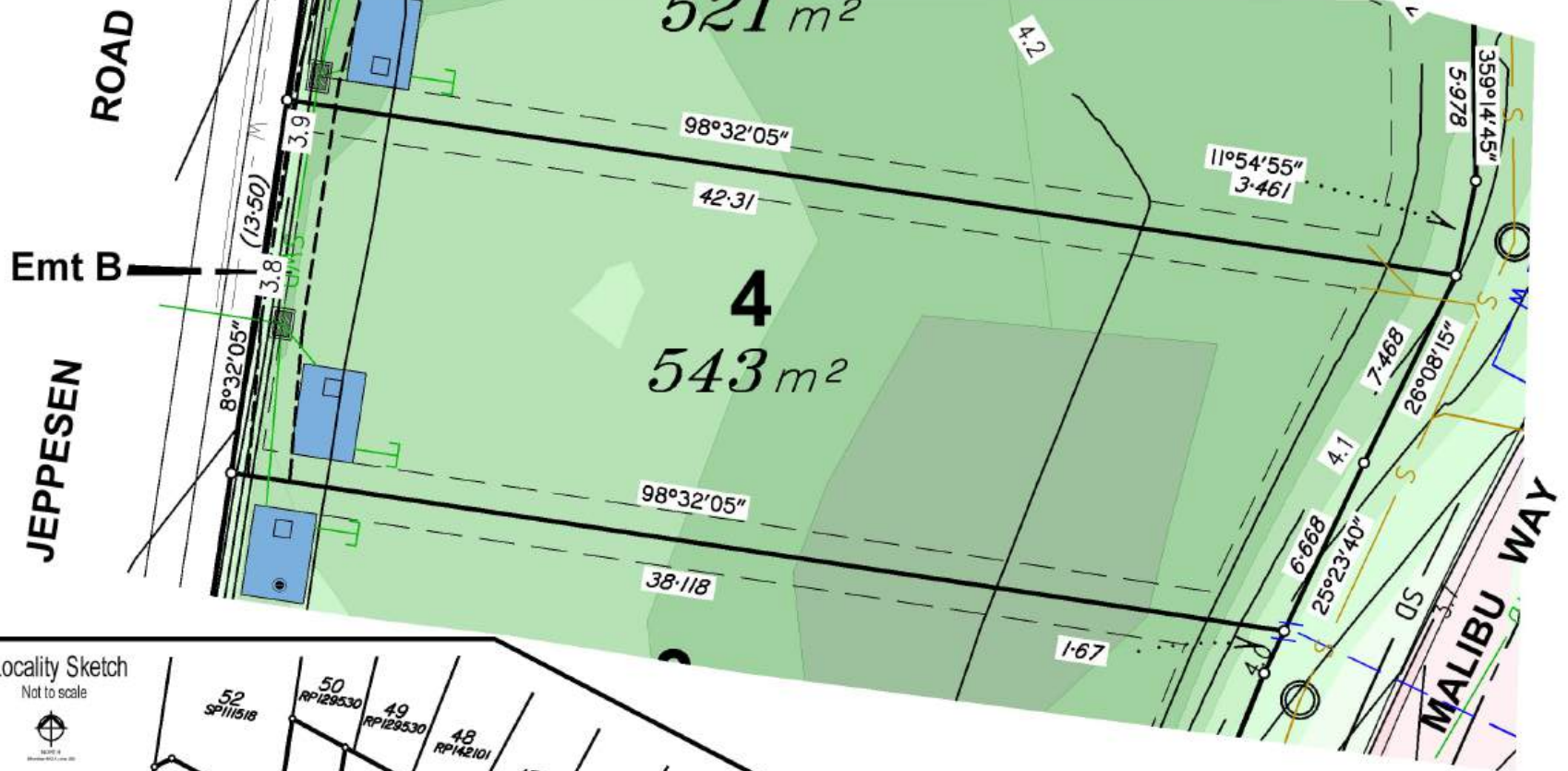

**Locality Sketch**

Not to scale



**Notes**

No part of this plan may be copied unless this note is included.

This plan has been prepared for Mywash Pty Ltd for the purpose of disclosure under the Land Sales Act. It is not to be used by any other person's or corporation's or for any other purpose.



NORTH  
 (Meridian MGA zone 56)



**Trilogy**  
 Survey Solutions

CONSULTING SURVEYORS  
 MERMAID WATERS | GOLD COAST

0431 400 670  
 wayneg@trilogys.com.au

# Disclosure Plan Proposed Lot 5 on SP347417

Current RP Description: Lot 1 on RP142419

Level Datum: AHD vide PSM70607

Project Meridian: MGA zone 56

### Legend: Design

- Stormwater Line
- Stormwater Tank
- Sewer Line
- Water Line
- Earthworks Pad
- Design Contours

### Cut / Fill

- |              |               |
|--------------|---------------|
| 3.0-2.5m Cut | 0.0-0.5m Fill |
| 2.5-2.0m Cut | 0.5-1.0m Fill |
| 2.0-1.5m Cut | 1.0-1.5m Fill |
| 1.5-1.0m Cut | 1.5-2.0m Fill |
| 1.0-0.5m Cut | 2.0-2.5m Fill |
| 0.5-0.0m Cut | 2.5-3.0m Fill |

Compaction of all fill placed as part of the civil works program is to be inspected and tested to Level 1 Inspection and Testing Standards in accordance with the Australian Standard AS 3798 - 2007, "Guidelines on Earthworks for Commercial and Residential Developments".

Any licence to use, reference or reproduce this document for any purpose whatsoever is restricted to the terms of the agreement between Trilogy Survey Solutions and the instructing party.

The property boundaries shown on this plan have been compiled from draft survey plan SP347417 DRAFT and are subject to final survey and local authority approvals.

Ancillary information (areas of fill, services, streetscaping, etc) is compiled from engineering design provided by ADG drawing numbers 27303\_C01-C43 Rev A. This information is indicative only and is subject to the approval of relevant authorities and civil construction.

Relevant development approvals relating to this project are RAL 23/0103 and OPW 24/0054.

This plan should be read with reference to the proposed draft survey plan SP347417 DRAFT and the approved engineering design plans.

AMENDMENTS	DATE
A	
B	

TRILOGY SURVEY SOLUTIONS PTY LTD  
(ACN 659 242 538) certify that the details  
shown on this sketch plan are correct

30/8/2024  
Date

Scale:   
1:250 (Before Reduction)

Drawing Number: TSS-231049-001-A Sheet 5 of 16

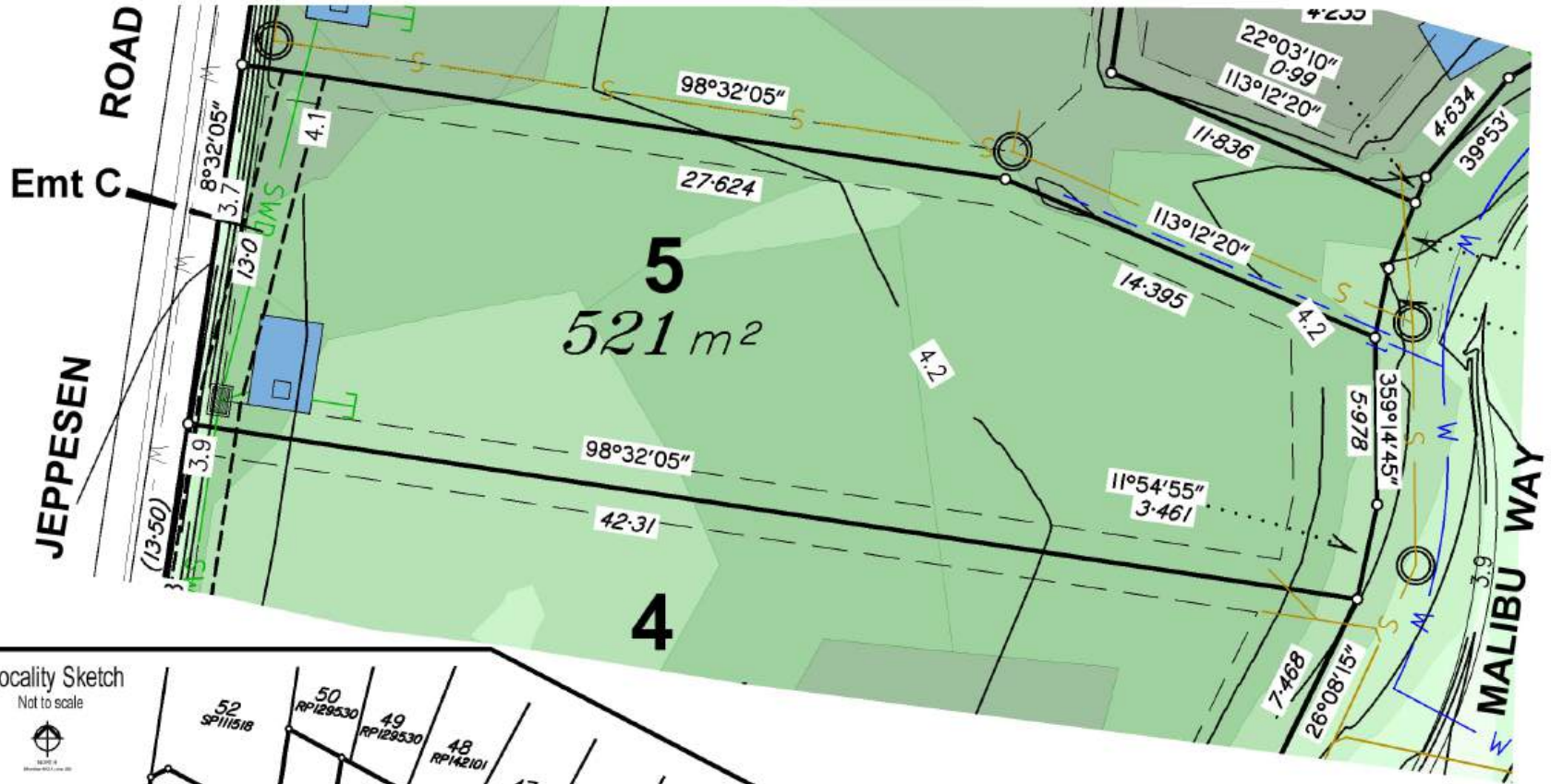

### Locality Sketch

Not to scale



### Notes

No part of this plan may be copied unless this note is included.

This plan has been prepared for Mywash Pty Ltd for the purpose of disclosure under the Land Sales Act. It is not to be used by any other person's or corporation's or for any other purpose.



NORTH  
(Meridian MGA zone 56)



**Trilogy**  
Survey Solutions

CONSULTING SURVEYORS  
MERMAID WATERS | GOLD COAST

0431 400 670

wayneg@trilogys.com.au

# Disclosure Plan Proposed Lot 6 on SP347417

Current RP Description: Lot 1 on RP142419

Level Datum: AHD vide PSM70607

Project Meridian: MGA zone 56

## Legend: Design

- Stormwater Line
- Stormwater Tank
- Sewer Line
- Water Line
- Earthworks Pad
- 3.9 Design Contours

## Cut / Fill

- |              |               |
|--------------|---------------|
| 3.0-2.5m Cut | 0.0-0.5m Fill |
| 2.5-2.0m Cut | 0.5-1.0m Fill |
| 2.0-1.5m Cut | 1.0-1.5m Fill |
| 1.5-1.0m Cut | 1.5-2.0m Fill |
| 1.0-0.5m Cut | 2.0-2.5m Fill |
| 0.5-0.0m Cut | 2.5-3.0m Fill |

Compaction of all fill placed as part of the civil works program is to be inspected and tested to Level 1 Inspection and Testing Standards in accordance with the Australian Standard AS 3798 - 2007, "Guidelines on Earthworks for Commercial and Residential Developments".

Any licence to use, reference or reproduce this document for any purpose whatsoever is restricted to the terms of the agreement between Trilogy Survey Solutions and the instructing party.

The property boundaries shown on this plan have been compiled from draft survey plan SP347417 DRAFT and are subject to final survey and local authority approvals.

Ancillary information (areas of fill, services, streetscaping, etc) is compiled from engineering design provided by ADG drawing numbers 27303\_C01-C43 Rev A. This information is indicative only and is subject to the approval of relevant authorities and civil construction.

Relevant development approvals relating to this project are RAL 23/0103 and OPW 24/0054.

This plan should be read with reference to the proposed draft survey plan SP347417 DRAFT and the approved engineering design plans.

AMENDMENTS	DATE
A	
B	

TRILOGY SURVEY SOLUTIONS PTY LTD  
(ACN 659 242 538) certify that the details  
shown on this sketch plan are correct

30/8/2024  
Date

Scale: 0 2.5 5 7.5  
1:250 (Before Reduction)

Drawing Number: TSS-231049-001-A Sheet 6 of 16



## Locality Sketch

Not to scale



## Notes

No part of this plan may be copied unless this note is included.

This plan has been prepared for Mywash Pty Ltd for the purpose of disclosure under the Land Sales Act. It is not to be used by any other person's or corporation's or for any other purpose.



NORTH  
(Meridian MGA zone 56)



**Trilogy**  
Survey Solutions

CONSULTING SURVEYORS  
MERMAID WATERS | GOLD COAST

0431 400 670

wayneg@trilogys.com.au

# Disclosure Plan Proposed Lot 7 on SP347417

Current RP Description: Lot 1 on RP142419

Level Datum: AHD vide PSM70607

Project Meridian: MGA zone 56

### Legend: Design

- Stormwater Line
- Stormwater Tank
- Sewer Line
- Water Line
- Earthworks Pad
- Design Contours

### Cut / Fill

- |              |               |
|--------------|---------------|
| 3.0-2.5m Cut | 0.0-0.5m Fill |
| 2.5-2.0m Cut | 0.5-1.0m Fill |
| 2.0-1.5m Cut | 1.0-1.5m Fill |
| 1.5-1.0m Cut | 1.5-2.0m Fill |
| 1.0-0.5m Cut | 2.0-2.5m Fill |
| 0.5-0.0m Cut | 2.5-3.0m Fill |

Compaction of all fill placed as part of the civil works program is to be inspected and tested to Level 1 Inspection and Testing Standards in accordance with the Australian Standard AS 3798 - 2007, "Guidelines on Earthworks for Commercial and Residential Developments".

Any licence to use, reference or reproduce this document for any purpose whatsoever is restricted to the terms of the agreement between Trilogy Survey Solutions and the instructing party.

The property boundaries shown on this plan have been compiled from draft survey plan SP347417 DRAFT and are subject to final survey and local authority approvals.

Ancillary information (areas of fill, services, streetscaping, etc) is compiled from engineering design provided by ADG drawing numbers 27303\_C01-C43 Rev A. This information is indicative only and is subject to the approval of relevant authorities and civil construction.

Relevant development approvals relating to this project are RAL 23/0103 and OPW 24/0054.

This plan should be read with reference to the proposed draft survey plan SP347417 DRAFT and the approved engineering design plans.

AMENDMENTS	DATE
A	
B	

TRILOGY SURVEY SOLUTIONS PTY LTD  
(ACN 659 242 538) certify that the details  
shown on this sketch plan are correct

30/8/2024  
Date

Scale: 0 2.5 5 7.5  
1:250 (Before Reduction)

@A4  
Drawing Number: TSS-231049-001-A Sheet 7 of 16

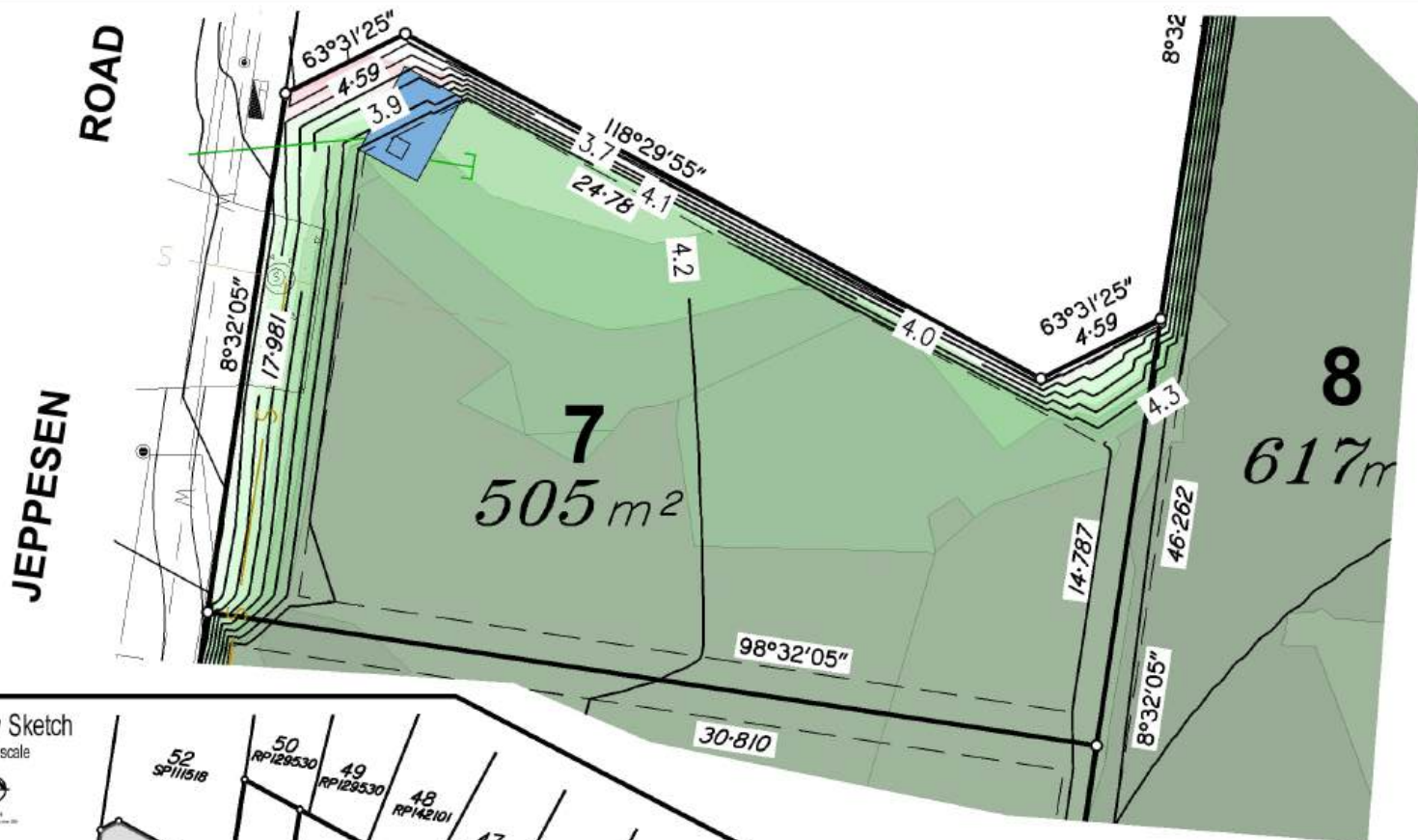

### Locality Sketch

Not to scale



### Notes

No part of this plan may be copied unless this note is included.

This plan has been prepared for Mywash Pty Ltd for the purpose of disclosure under the Land Sales Act. It is not to be used by any other person's or corporation's or for any other purpose.



NORTH  
(Meridian MGA zone 56)



**Trilogy**  
Survey Solutions

CONSULTING SURVEYORS  
MERMAID WATERS | GOLD COAST

☎ 0431 400 670

✉ wayneg@trilogys.com.au







# Disclosure Plan Proposed Lot 8 on SP347417

Current RP Description: Lot 1 on RP142419













Level Datum: AHD vide PSM70607

Project Meridian: MGA zone 56

## Legend: Design

-  Stormwater Line
-  Stormwater Tank
-  Sewer Line
-  Water Line
-  Earthworks Pad
-  3.9 Design Contours

## Cut / Fill

- |  |              |   |               |
|--|--------------|---|---------------|
|  | 3.0-2.5m Cut |  | 0.0-0.5m Fill |
|  | 2.5-2.0m Cut |  | 0.5-1.0m Fill |
|  | 2.0-1.5m Cut |  | 1.0-1.5m Fill |
|  | 1.5-1.0m Cut |  | 1.5-2.0m Fill |
|  | 1.0-0.5m Cut |  | 2.0-2.5m Fill |
|  | 0.5-0.0m Cut |  | 2.5-3.0m Fill |

Compaction of all fill placed as part of the civil works program is to be inspected and tested to Level 1 Inspection and Testing Standards in accordance with the Australian Standard AS 3798 - 2007, "Guidelines on Earthworks for Commercial and Residential Developments".

Any licence to use, reference or reproduce this document for any purpose whatsoever is restricted to the terms of the agreement between Trilogy Survey Solutions and the instructing party.

The property boundaries shown on this plan have been compiled from draft survey plan SP347417 DRAFT and are subject to final survey and local authority approvals.

Ancillary information (areas of fill, services, streetscaping, etc) is compiled from engineering design provided by ADG drawing numbers 27303\_C01-C43 Rev A. This information is indicative only and is subject to the approval of relevant authorities and civil construction.

Relevant development approvals relating to this project are RAL 23/0103 and OPW 24/0054.

This plan should be read with reference to the proposed draft survey plan SP347417 DRAFT and the approved engineering design plans.



**Notes**  
No part of this plan may be copied unless this note is included.  
This plan has been prepared for Mywash Pty Ltd for the purpose of disclosure under the Land Sales Act. It is not to be used by any other person's or corporation's or for any other purpose.

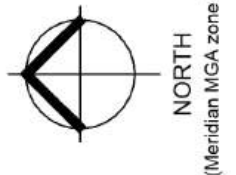

AMENDMENTS	DATE
A	
B	

TRILOGY SURVEY SOLUTIONS PTY LTD (ACN 659 242 538) certify that the details shown on this sketch plan are correct

 30/8/2024  
Date

Scale:   
1:250 (Before Reduction)

Drawing Number: TSS-231049-001-A Sheet 8 of 16



## Trilogy Survey Solutions

CONSULTING SURVEYORS  
MERMAID WATERS | GOLD COAST

0431 400 670  
wayneg@trilogys.com.au

# Disclosure Plan Proposed Lot 9 on SP347417

Current RP Description: Lot 1 on RP142419

Level Datum: AHD vide PSM70607

Project Meridian: MGA zone 56

## Legend: Design

- Stormwater Line
- Stormwater Tank
- Sewer Line
- Water Line
- Earthworks Pad
- 3.9 Design Contours

## Cut / Fill

- |  |              |  |               |
|--|--------------|--|---------------|
|  | 3.0-2.5m Cut |  | 0.0-0.5m Fill |
|  | 2.5-2.0m Cut |  | 0.5-1.0m Fill |
|  | 2.0-1.5m Cut |  | 1.0-1.5m Fill |
|  | 1.5-1.0m Cut |  | 1.5-2.0m Fill |
|  | 1.0-0.5m Cut |  | 2.0-2.5m Fill |
|  | 0.5-0.0m Cut |  | 2.5-3.0m Fill |

Compaction of all fill placed as part of the civil works program is to be inspected and tested to Level 1 Inspection and Testing Standards in accordance with the Australian Standard AS 3798 - 2007, "Guidelines on Earthworks for Commercial and Residential Developments".

Any licence to use, reference or reproduce this document for any purpose whatsoever is restricted to the terms of the agreement between Trilogy Survey Solutions and the instructing party.

The property boundaries shown on this plan have been compiled from draft survey plan SP347417 DRAFT and are subject to final survey and local authority approvals.

Ancillary information (areas of fill, services, streetscaping, etc) is compiled from engineering design provided by ADG drawing numbers 27303\_C01-C43 Rev A. This information is indicative only and is subject to the approval of relevant authorities and civil construction.

Relevant development approvals relating to this project are RAL 23/0103 and OPW 24/0054.

This plan should be read with reference to the proposed draft survey plan SP347417 DRAFT and the approved engineering design plans.

AMENDMENTS	DATE
A	
B	

TRILOGY SURVEY SOLUTIONS PTY LTD  
(ACN 659 242 538) certify that the details  
shown on this sketch plan are correct

30/8/2024  
Date

Scale: 1:250 (Before Reduction)

Drawing Number: TSS-231049-001-A Sheet 9 of 16



MALIBU WAY

## Locality Sketch

Not to scale

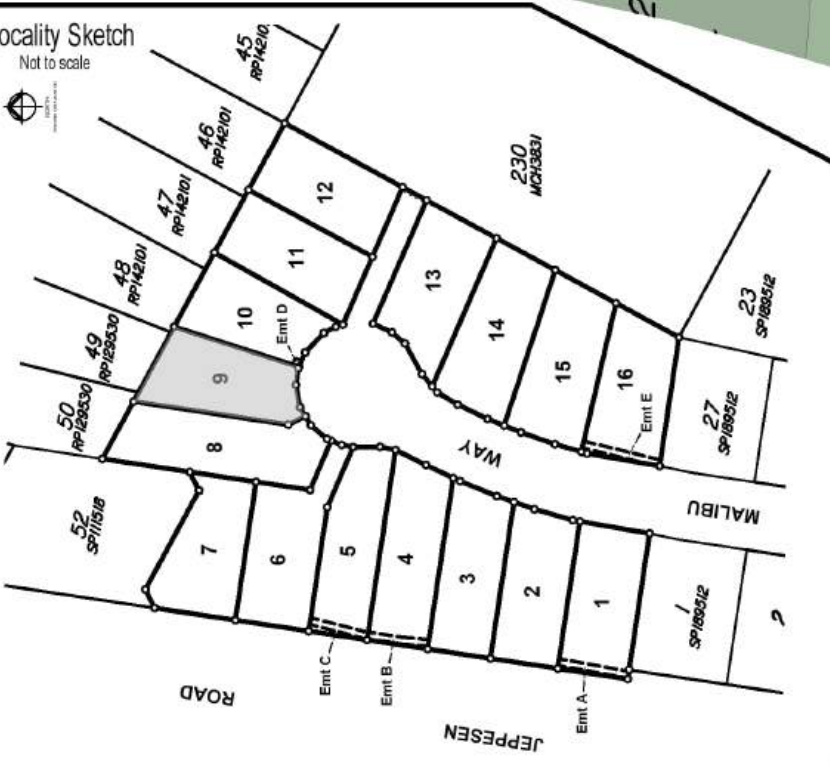

## Notes

No part of this plan may be copied unless this note is included.

This plan has been prepared for Mywash Pty Ltd for the purpose of disclosure under the Land Sales Act. It is not to be used by any other person's or corporation's or for any other purpose.

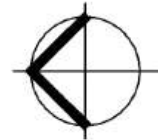

NORTH  
(Meridian MGA zone 56)



**Trilogy**  
Survey Solutions

CONSULTING SURVEYORS  
MERMAID WATERS | GOLD COAST

0431 400 670

wayneg@trilogys.com.au

**Disclosure Plan**  
**Proposed Lot 10 on SP347417**

Current RP Description: Lot 1 on RP142419

Level Datum: AHD vide PSM70607

Project Meridian: MGA zone 56

**Legend: Design**

- Stormwater Line
- Stormwater Tank
- Sewer Line
- Water Line
- Earthworks Pad
- Design Contours

**Cut / Fill**

- |              |               |
|--------------|---------------|
| 3.0-2.5m Cut | 0.0-0.5m Fill |
| 2.5-2.0m Cut | 0.5-1.0m Fill |
| 2.0-1.5m Cut | 1.0-1.5m Fill |
| 1.5-1.0m Cut | 1.5-2.0m Fill |
| 1.0-0.5m Cut | 2.0-2.5m Fill |
| 0.5-0.0m Cut | 2.5-3.0m Fill |

Compaction of all fill placed as part of the civil works program is to be inspected and tested to Level 1 Inspection and Testing Standards in accordance with the Australian Standard AS 3798 - 2007, "Guidelines on Earthworks for Commercial and Residential Developments".

Any licence to use, reference or reproduce this document for any purpose whatsoever is restricted to the terms of the agreement between Trilogy Survey Solutions and the instructing party.

The property boundaries shown on this plan have been compiled from draft survey plan SP347417 DRAFT and are subject to final survey and local authority approvals.

Ancillary information (areas of fill, services, streetscaping, etc) is compiled from engineering design provided by ADG drawing numbers 27303\_C01-C43 Rev A. This information is indicative only and is subject to the approval of relevant authorities and civil construction.

Relevant development approvals relating to this project are RAL 23/0103 and OPW 24/0054.

This plan should be read with reference to the proposed draft survey plan SP347417 DRAFT and the approved engineering design plans.

**Locality Sketch**

Not to scale

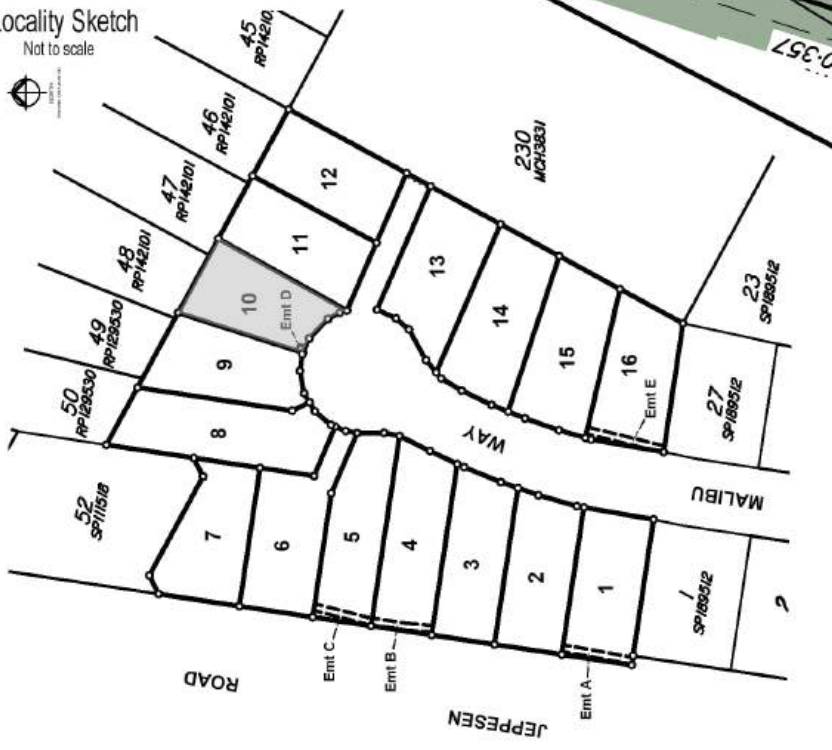

AMENDMENTS	DATE
A	
B	

TRILOGY SURVEY SOLUTIONS PTY LTD  
 (ACN 659 242 538) certify that the details  
 shown on this sketch plan are correct

30/8/2024  
 Date

Scale:   
 1: 250 (Before Reduction)

Drawing Number: TSS-231049-001-A Sheet 10 of 16



**Notes**  
 No part of this plan may be copied unless this note is included.  
 This plan has been prepared for Mywash Pty Ltd for the purpose of disclosure under the Land Sales Act. It is not to be used by any other person's or corporation's or for any other purpose.

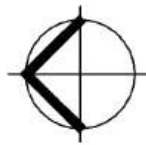

NORTH  
 (Meridian MGA zone 56)

**TRILOGY**  
**Trilogy**  
**Survey Solutions**

CONSULTING SURVEYORS  
 MERMAID WATERS | GOLD COAST

0431 400 670  
 wayneg@trilogys.com.au

# Disclosure Plan Proposed Lot 11 on SP347417

Current RP Description: Lot 1 on RP142419

Level Datum: AHD vide PSM70607

Project Meridian: MGA zone 56

### Legend: Design

- Stormwater Line
- Stormwater Tank
- Sewer Line
- Water Line
- Earthworks Pad
- 3.9 Design Contours

### Cut / Fill

- |              |               |
|--------------|---------------|
| 3.0-2.5m Cut | 0.0-0.5m Fill |
| 2.5-2.0m Cut | 0.5-1.0m Fill |
| 2.0-1.5m Cut | 1.0-1.5m Fill |
| 1.5-1.0m Cut | 1.5-2.0m Fill |
| 1.0-0.5m Cut | 2.0-2.5m Fill |
| 0.5-0.0m Cut | 2.5-3.0m Fill |

Compaction of all fill placed as part of the civil works program is to be inspected and tested to Level 1 Inspection and Testing Standards in accordance with the Australian Standard AS 3798 - 2007, "Guidelines on Earthworks for Commercial and Residential Developments".

Any licence to use, reference or reproduce this document for any purpose whatsoever is restricted to the terms of the agreement between Trilogy Survey Solutions and the instructing party.

The property boundaries shown on this plan have been compiled from draft survey plan SP347417 DRAFT and are subject to final survey and local authority approvals.

Ancillary information (areas of fill, services, streetscaping, etc) is compiled from engineering design provided by ADG drawing numbers 27303\_C01-C43 Rev A. This information is indicative only and is subject to the approval of relevant authorities and civil construction.

Relevant development approvals relating to this project are RAL 23/0103 and OPW 24/0054.

This plan should be read with reference to the proposed draft survey plan SP347417 DRAFT and the approved engineering design plans.

AMENDMENTS	DATE
A	
B	

TRILOGY SURVEY SOLUTIONS PTY LTD  
(ACN 659 242 538) certify that the details  
shown on this sketch plan are correct

30/8/2024  
Date

Scale: 1:250 (Before Reduction)

Drawing Number: TSS-231049-001-A Sheet 11 of 16



### Locality Sketch

Not to scale



### Notes

No part of this plan may be copied unless this note is included.

This plan has been prepared for Mywash Pty Ltd for the purpose of disclosure under the Land Sales Act. It is not to be used by any other person's or corporation's or for any other purpose.



## Trilogy Survey Solutions

CONSULTING SURVEYORS  
MERMAID WATERS | GOLD COAST

0431 400 670

wayneg@trilogys.com.au

# Disclosure Plan Proposed Lot 12 on SP347417

Current RP Description: Lot 1 on RP142419

Level Datum: AHD vide PSM70607

Project Meridian: MGA zone 56

## Legend: Design

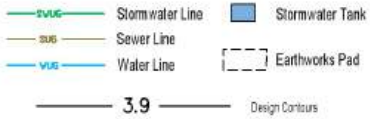

## Cut / Fill

3.0-2.5m Cut	0.0-0.5m Fill
2.5-2.0m Cut	0.5-1.0m Fill
2.0-1.5m Cut	1.0-1.5m Fill
1.5-1.0m Cut	1.5-2.0m Fill
1.0-0.5m Cut	2.0-2.5m Fill
0.5-0.0m Cut	2.5-3.0m Fill

Compaction of all fill placed as part of the civil works program is to be inspected and tested to Level 1 Inspection and Testing Standards in accordance with the Australian Standard AS 3798 - 2007, "Guidelines on Earthworks for Commercial and Residential Developments".

Any licence to use, reference or reproduce this document for any purpose whatsoever is restricted to the terms of the agreement between Trilogy Survey Solutions and the instructing party.

The property boundaries shown on this plan have been compiled from draft survey plan SP347417 DRAFT and are subject to final survey and local authority approvals.

Ancillary information (areas of fill, services, streetscaping, etc) is compiled from engineering design provided by ADG drawing numbers 27303\_C01-C43 Rev A. This information is indicative only and is subject to the approval of relevant authorities and civil construction.

Relevant development approvals relating to this project are RAL 23/0103 and OPW 24/0054.

This plan should be read with reference to the proposed draft survey plan SP347417 DRAFT and the approved engineering design plans.

AMENDMENTS	DATE
DESCRIPTION	
A	
B	

TRILOGY SURVEY SOLUTIONS PTY LTD (ACN 659 242 538) certify that the details shown on this sketch plan are correct

 30/8/2024  
Date

Scale:   
1:250 (Before Reduction)

Drawing Number: TSS-231049-001-A Sheet 12 of 16

## Notes

No part of this plan may be copied unless this note is included.

This plan has been prepared for Mywash Pty Ltd for the purpose of disclosure under the Land Sales Act. It is not to be used by any other person's or corporation's or for any other purpose.



NORTH  
(Meridian MGA zone 56)

## Locality Sketch

Not to scale

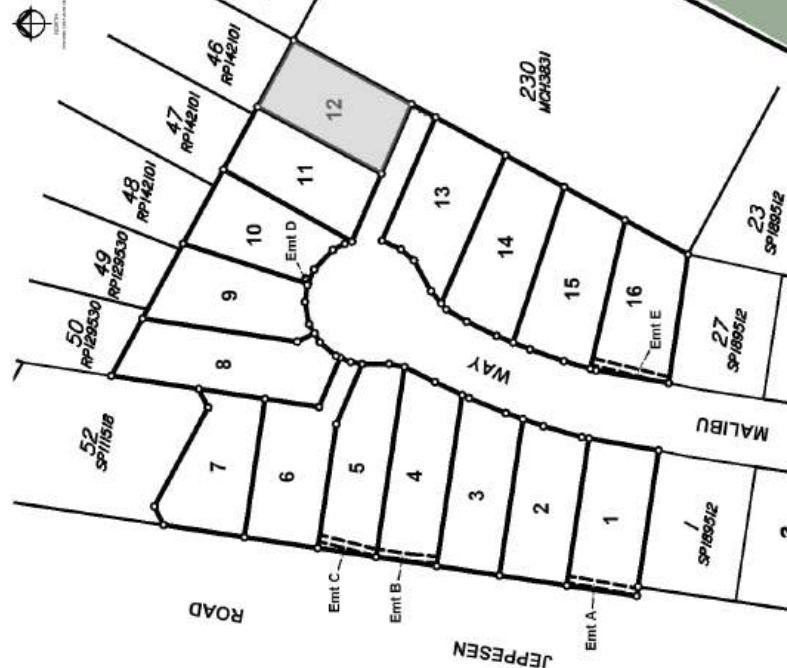

**Trilogy**  
Survey Solutions

CONSULTING SURVEYORS  
MERMAID WATERS | GOLD COAST

0431 400 670

wayneg@trilogys.com.au

# Disclosure Plan Proposed Lot 13 on SP347417

Current RP Description: Lot 1 on RP142419

Level Datum: AHD vide PSM70607

Project Meridian: MGA zone 56

## Legend: Design

- Stormwater Line
- Sewer Line
- Water Line
- Stormwater Tank
- Earthworks Pad
- Design Contours

## Cut / Fill

- |              |               |
|--------------|---------------|
| 3.0-2.5m Cut | 0.0-0.5m Fill |
| 2.5-2.0m Cut | 0.5-1.0m Fill |
| 2.0-1.5m Cut | 1.0-1.5m Fill |
| 1.5-1.0m Cut | 1.5-2.0m Fill |
| 1.0-0.5m Cut | 2.0-2.5m Fill |
| 0.5-0.0m Cut | 2.5-3.0m Fill |

Compaction of all fill placed as part of the civil works program is to be inspected and tested to Level 1 Inspection and Testing Standards in accordance with the Australian Standard AS 3798 - 2007, "Guidelines on Earthworks for Commercial and Residential Developments".

Any licence to use, reference or reproduce this document for any purpose whatsoever is restricted to the terms of the agreement between Trilogy Survey Solutions and the instructing party.

The property boundaries shown on this plan have been compiled from draft survey plan SP347417 DRAFT and are subject to final survey and local authority approvals.

Ancillary information (areas of fill, services, streetscaping, etc) is compiled from engineering design provided by ADG drawing numbers 27303\_C01-C43 Rev A. This information is indicative only and is subject to the approval of relevant authorities and civil construction.

Relevant development approvals relating to this project are RAL 23/0103 and OPW 24/0054.

This plan should be read with reference to the proposed draft survey plan SP347417 DRAFT and the approved engineering design plans.



**Notes**

No part of this plan may be copied unless this note is included.

This plan has been prepared for Mywash Pty Ltd for the purpose of disclosure under the Land Sales Act. It is not to be used by any other person's or corporation's or for any other purpose.



AMENDMENTS	DATE
A	
B	

TRILOGY SURVEY SOLUTIONS PTY LTD (ACN 659 242 538) certify that the details shown on this sketch plan are correct

30/8/2024  
Date

Scale: 1:250 (Before Reduction)

Drawing Number: TSS-231049-001-A Sheet 13 of 16

**Trilogy Survey Solutions**

CONSULTING SURVEYORS  
MERMAID WATERS | GOLD COAST

☎ 0431 400 670  
✉ wayneg@trilogys.com.au









**Disclosure Plan**  
**Proposed Lot 15 on SP347417**

Current RP Description: Lot 1 on RP142419













Level Datum: AHD vide PSM70607

Project Meridian: MGA zone 56

**Legend: Design**

-  Stormwater Line
-  Stormwater Tank
-  Sewer Line
-  Earthworks Pad
-  Water Line
-  Earthworks Pad
-  3.9 Design Contours

**Cut / Fill**

- |   |   |
|---|---|
|  3.0-2.5m Cut |  0.0-0.5m Fill |
|  2.5-2.0m Cut |  0.5-1.0m Fill |
|  2.0-1.5m Cut |  1.0-1.5m Fill |
|  1.5-1.0m Cut |  1.5-2.0m Fill |
|  1.0-0.5m Cut |  2.0-2.5m Fill |
|  0.5-0.0m Cut |  2.5-3.0m Fill |

Compaction of all fill placed as part of the civil works program is to be inspected and tested to Level 1 Inspection and Testing Standards in accordance with the Australian Standard AS 3798 - 2007, "Guidelines on Earthworks for Commercial and Residential Developments".

Any licence to use, reference or reproduce this document for any purpose whatsoever is restricted to the terms of the agreement between Trilogy Survey Solutions and the instructing party.

The property boundaries shown on this plan have been compiled from draft survey plan SP347417 DRAFT and are subject to final survey and local authority approvals.

Ancillary information (areas of fill, services, streetscaping, etc) is compiled from engineering design provided by ADG drawing numbers 27303\_C01-C43 Rev A. This information is indicative only and is subject to the approval of relevant authorities and civil construction.

Relevant development approvals relating to this project are RAL 23/0103 and OPW 24/0054.

This plan should be read with reference to the proposed draft survey plan SP347417 DRAFT and the approved engineering design plans.

AMENDMENTS	DATE
DESCRIPTION	
A	
B	

TRILOGY SURVEY SOLUTIONS PTY LTD (ACN 659 242 538) certify that the details shown on this sketch plan are correct

 30/8/2024  
 Date

Scale:   
 1: 250 (Before Reduction)

Drawing Number: TSS-231049-001-A Sheet 15 of 16



**Notes**  
 No part of this plan may be copied unless this note is included.  
 This plan has been prepared for Mywash Pty Ltd for the purpose of disclosure under the Land Sales Act. It is not to be used by any other person's or corporation's or for any other purpose.



 **Trilogy**  
 Survey Solutions

CONSULTING SURVEYORS  
 MERMAID WATERS | GOLD COAST

☎ 0431 400 670  
 ✉ wayneg@trilogys.com.au

**Disclosure Plan**  
**Proposed Lot 16 on SP347417**

Current RP Description: Lot 1 on RP142419

Level Datum: AHD vide PSM70607

Project Meridian: MGA zone 56

**Legend: Design**

- Stormwater Line
- Stormwater Tank
- Sewer Line
- Water Line
- Earthworks Pad
- 3.9 Design Contours

**Cut / Fill**

- |              |               |
|--------------|---------------|
| 3.0-2.5m Cut | 0.0-0.5m Fill |
| 2.5-2.0m Cut | 0.5-1.0m Fill |
| 2.0-1.5m Cut | 1.0-1.5m Fill |
| 1.5-1.0m Cut | 1.5-2.0m Fill |
| 1.0-0.5m Cut | 2.0-2.5m Fill |
| 0.5-0.0m Cut | 2.5-3.0m Fill |

Compaction of all fill placed as part of the civil works program is to be inspected and tested to Level 1 Inspection and Testing Standards in accordance with the Australian Standard AS 3798 - 2007, "Guidelines on Earthworks for Commercial and Residential Developments".

Any licence to use, reference or reproduce this document for any purpose whatsoever is restricted to the terms of the agreement between Trilogy Survey Solutions and the instructing party.

The property boundaries shown on this plan have been compiled from draft survey plan SP347417 DRAFT and are subject to final survey and local authority approvals.

Ancillary information (areas of fill, services, streetscaping, etc) is compiled from engineering design provided by ADG drawing numbers 27303\_C01-C43 Rev A. This information is indicative only and is subject to the approval of relevant authorities and civil construction.

Relevant development approvals relating to this project are RAL 23/0103 and OPW 24/0054.

This plan should be read with reference to the proposed draft survey plan SP347417 DRAFT and the approved engineering design plans.

AMENDMENTS	DATE
A	
B	

TRILOGY SURVEY SOLUTIONS PTY LTD (ACN 659 242 538) certify that the details shown on this sketch plan are correct

30/8/2024  
 Date

Scale: 0 2.5 5 7.5  
 1:250 (Before Reduction)

Drawing Number: TSS-231049-001-A Sheet 16 of 16

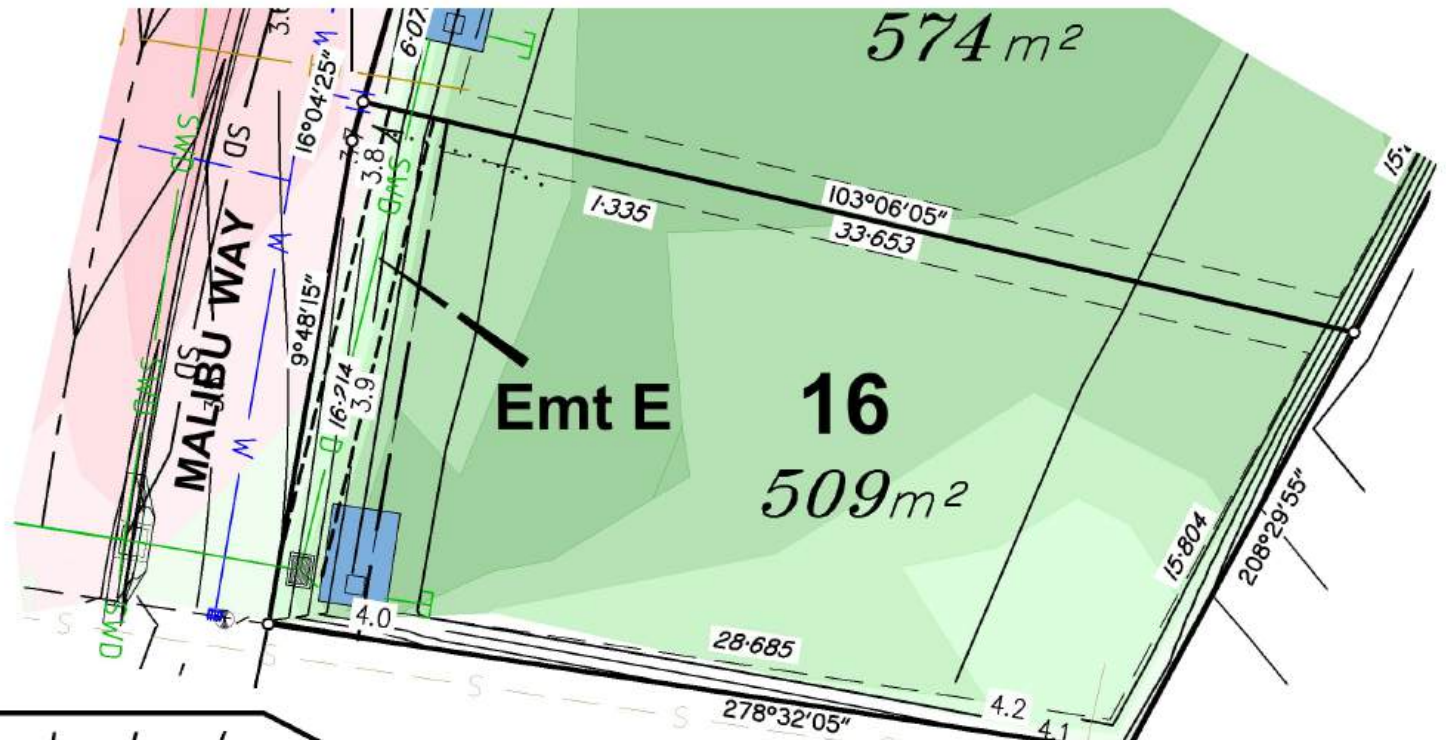

**Locality Sketch**

Not to scale



**Notes**

No part of this plan may be copied unless this note is included.

This plan has been prepared for Mywash Pty Ltd for the purpose of disclosure under the Land Sales Act. It is not to be used by any other person's or corporation's or for any other purpose.



**TRILOGY**  
**Trilogy**  
**Survey Solutions**

CONSULTING SURVEYORS  
 MERMAID WATERS | GOLD COAST

☎ 0431 400 670  
 ✉ wayneg@trilogys.com.au